



Bow Road, London, E3

BUTLER & STAG



Price Guide £475,000 - £500,000
Nestled between the historic Bow Church and the leafy open spaces of Grove Hall Park, this charming early 20th-century two-bedroom, two bathroom residence offers 954 Sq/Ft of well-proportioned accommodation.



Leasehold

- 954 Sq/Ft Internal Living Space
- Two Bedrooms
- Lift Access To All Levels
- Two Bathrooms
- Voluminous Ceiling Heights
- Open Plan Concept Living Space
- Bow Church (DLR) / Bow Road and Mile End Tube Station Close By
- Grove Hall Park / Westfield Shopping Centre Close By

Boasting tall ceilings throughout, the apartment feels bright and airy, enhancing the sense of volume across all rooms. The heart of the home is the impressive open-plan living and kitchen area, designed for entertaining, with generous proportions and an abundance of natural light.

The property features two well-sized double bedrooms, including a spacious principal bedroom with its own en-suite bathroom, alongside a second contemporary family bathroom. Thoughtfully laid out, the apartment provides both comfort and functionality, ideal for professionals or couples.

Located in a well-maintained development on Bow Road, Link House benefits from excellent transport connections, with nearby Underground and bus links providing easy access into the City, Canary Wharf, and beyond. A range of local amenities, green spaces, and vibrant East London hotspots are all within easy reach.

This is a fantastic opportunity to acquire a stylish and generously proportioned home in a highly convenient and well-connected location.





Link House, E3

Approx Gross Internal Area : 88.7 sq m / 954 sq ft

BUTLER & STAG

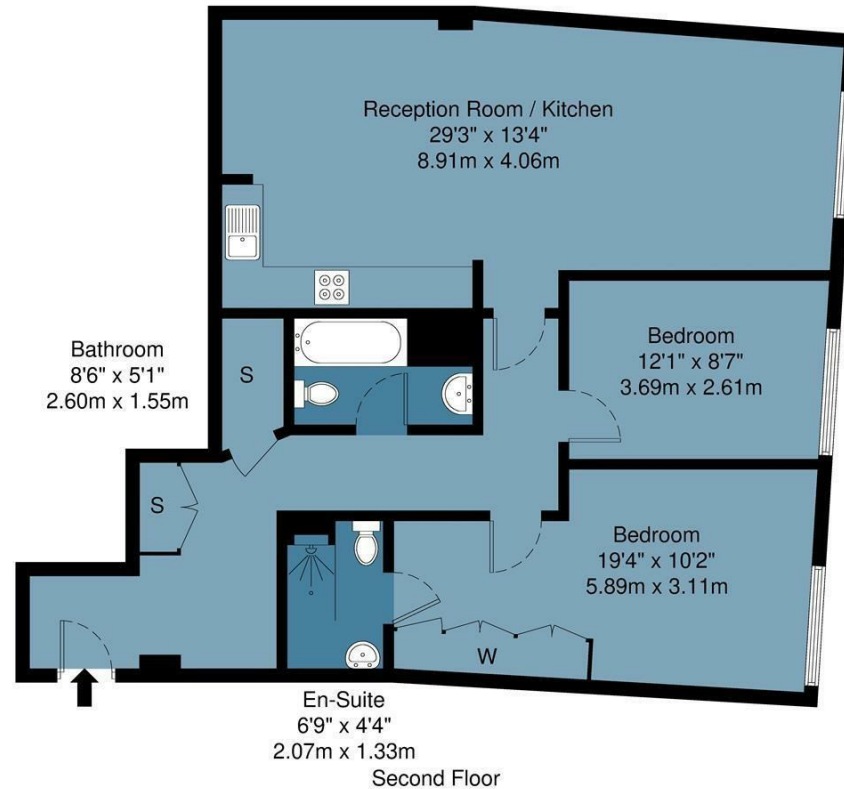

Measurements are approximate and for illustration purposes only. While we do not doubt the accuracy and completeness, we advise you conduct a careful independent assessment of the property to determine monetary value.
© @ Maison VUE | www.maisonvue.com

BUTLER & STAG

☎ 020 8102 1236

🏠 508 Roman Road, Bow, London, E3 5LU

✉ bow@butlerandstag.com

IMPORTANT NOTICE - These particulars have been prepared in good faith and they are not intended to constitute part of an offer or contract. We have not performed a structural survey on this property and the services, appliances and specific fittings have not been tested. All photographs, measurements, floor plans and distances referred to are given as a guide and should not be relied upon.

www.butlerandstag.uk